

# SHIMANO

*Metanium* SA-RB

**META-HGL**

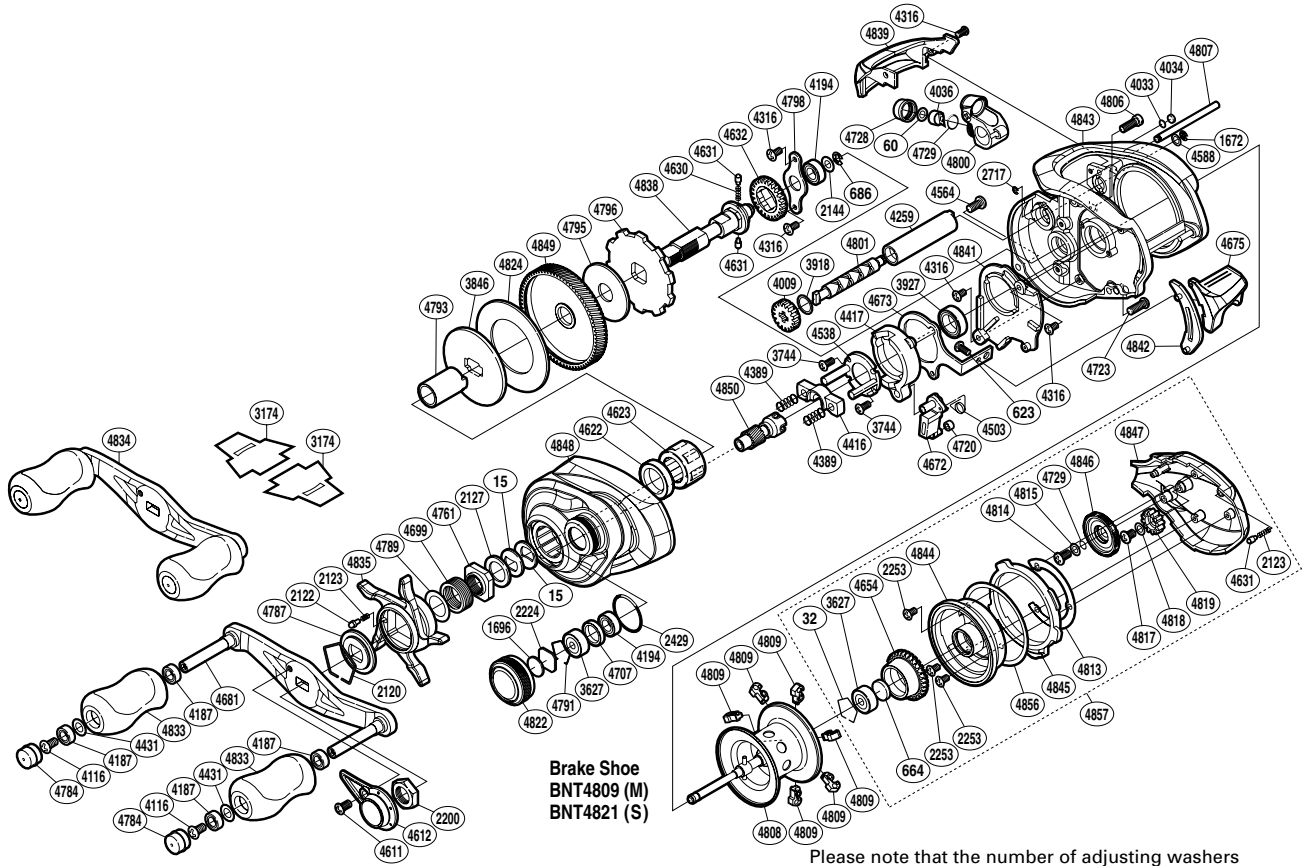

(51RH753000U)

Please note that the number of adjusting washers may not be the same as shown in the exploded views. (Adjustment will vary with each individual product.)

| Part No. | Description          | Part No. | Description                | Part No. | Description                  |
|----------|----------------------|----------|----------------------------|----------|------------------------------|
| BNT0015  | Drag Spring Washer   | BNT4417  | Clutch Cam                 | BNT4801  | Worm Shaft                   |
| BNT0032  | Bearing Retainer     | BNT4431  | Washer                     | BNT4806  | Screw                        |
| BNT0060  | Spacer               | BNT4503  | Clutch Pawl Spring         | BNT4807  | Level Wind Guide             |
| BNT0623  | Screw                | BNT4538  | Clutch Cam Retainer        | BNT4808  | Spool Assembly               |
| BNT0664  | Spacer B             | BNT4564  | Screw                      | BNT4809  | Brake Shoe M                 |
| BNT0686  | E Lock               | BNT4588  | Washer                     | BNT4813  | Brake Case Washer            |
| BNT1672  | E Lock               | BNT4611  | Screw                      | BNT4814  | Screw                        |
| BNT1696  | Cast Control Spacer  | BNT4612  | Handle Retainer            | BNT4815  | Washer                       |
| BNT2120  | Click Plate Retainer | BNT4622  | Drive Shaft Holder Bushing | BNT4817  | Screw                        |
| BNT2122  | Click Pin            | BNT4623  | Roller Clutch Bearing      | BNT4818  | Washer                       |
| BNT2123  | Click Spring         | BNT4630  | Idle Gear Spring           | BNT4819  | Idle Gear                    |
| BNT2127  | Star Drag Spacer     | BNT4631  | Idle Gear Pin              | BNT4822  | Cast Control Cap             |
| BNT2144  | Washer               | BNT4632  | Idle Gear                  | BNT4824  | Drag Washer                  |
| BNT2200  | Handle Nut           | BNT4654  | Brake Pipe Gear            | BNT4833  | Handle Knob                  |
| BNT2224  | Spool Tension Spacer | BNT4672  | Clutch Pawl                | BNT4834  | Handle Assembly              |
| BNT2253  | Screw                | BNT4673  | Clutch Plate               | BNT4835  | Star Drag                    |
| BNT2429  | O Ring               | BNT4675  | Quick-Fire II Clutch Bar   | BNT4838  | Drive Shaft                  |
| BNT2717  | E Lock               | BNT4681  | Handle Shank Assembly      | BNT4839  | Level Wind Protector         |
| BNT3627  | Ball Bearing         | BNT4699  | Star Drag Spring           | BNT4841  | Clutch Guard                 |
| BNT3744  | Screw                | BNT4707  | Bearing Spacer             | BNT4842  | Clutch Bar Guide             |
| BNT3846  | Key Washer           | BNT4720  | Clutch Pawl Bushing        | BNT4843  | One-Piece Frame              |
| BNT3918  | Washer               | BNT4723  | Screw                      | BNT4844  | Brake Case                   |
| BNT3927  | Ball Bearing         | BNT4728  | Pawl Cap                   | BNT4845  | Side Plate Cam Lever         |
| BNT4009  | Idle Gear            | BNT4729  | O Ring                     | BNT4846  | BR Dial                      |
| BNT4033  | Washer               | BNT4761  | Star Drag Nut              | BNT4847  | Right Side Plate             |
| BNT4034  | Anti-Thrust Washer   | BNT4784  | Handle Knob Seal           | BNT4848  | Left Side Plate              |
| BNT4036  | Line Guide Pawl      | BNT4787  | Star Drag Click Plate      | BNT4849  | Drive Gear                   |
| BNT4116  | Screw                | BNT4789  | Washer                     | BNT4850  | Pinion Gear                  |
| BNT4187  | Ball Bearing         | BNT4791  | Bearing Retainer           | BNT4856  | Washer                       |
| BNT4194  | Ball Bearing         | BNT4793  | Roller Clutch Inner Tube   | BNT4857  | Right Side Plate Assembly    |
| BNT4259  | Level Wind Guard     | BNT4795  | Drag Washer                |          |                              |
| BNT4316  | Screw                | BNT4796  | Anti-Reverse Ratchet       | BNT3174  | Reel Seat Spacer (accessory) |
| BNT4389  | Yoke Spring          | BNT4798  | Drive Shaft Retainer       | BNT4692  | B-100 Oil (accessory)        |
| BNT4416  | Yoke                 | BNT4800  | Line Guide                 | BNT4821  | Brake Shoe S (accessory)     |