

# SHIMANO

CURADO 

CU-201E7

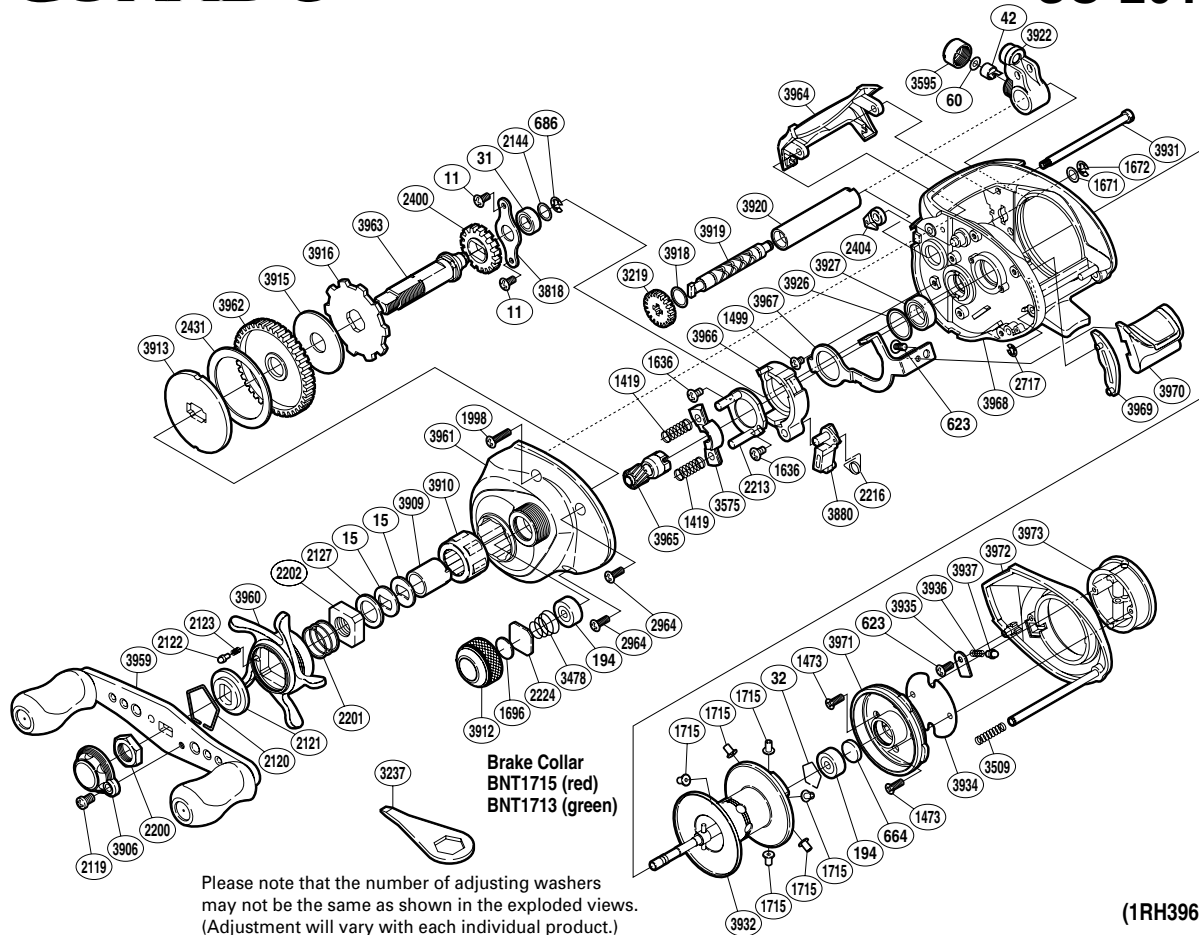

(1RH396201U)

Part No.	Description	Part No.	Description	Part No.	Description
BNT0011	Screw	BNT2201	Star Drag Spring	BNT3922	Line Guide
BNT0015	Drag Spring Washer	BNT2202	Star Drag Nut	BNT3926	Washer
BNT0031	Ball Bearing	BNT2213	Clutch Cam Retainer	BNT3927	Ball Bearing
BNT0032	Bearing Retainer	BNT2216	Clutch Pawl Spring	BNT3931	Level Wind Guide
BNT0042	Line Guide Pawl	BNT2224	Spool Tension Spacer	BNT3932	Spool Assembly
BNT0060	Spacer	BNT2400	Idle Gear	BNT3934	Brake Case Spacer
BNT0194	Ball Bearing	BNT2404	Anti-Reverse Pawl	BNT3935	Brake Spring Retainer
BNT0623	Screw	BNT2431	Drag Washer	BNT3936	Click Spring
BNT0664	Spacer B	BNT2717	E Lock	BNT3937	Click Pin
BNT0686	E Lock	BNT2964	Screw	BNT3959	Handle Assembly
BNT1419	Yoke Spring	BNT3219	Idle Gear	BNT3960	Star Drag
BNT1473	Screw	BNT3478	Spool Tension Spring	BNT3961	Left Side Plate
BNT1499	Screw	BNT3509	Side Plate Spring	BNT3962	Drive Gear
BNT1636	Screw	BNT3575	Yoke	BNT3963	Drive Shaft
BNT1671	Washer	BNT3595	Pawl Cap	BNT3964	Level Wind Protector
BNT1672	E Lock	BNT3818	Drive Shaft Retainer	BNT3965	Pinion Gear
BNT1696	Cast Control Spacer	BNT3880	Clutch Pawl	BNT3966	Clutch Cam
BNT1715	Brake Collar (red)	BNT3906	Handle Retainer	BNT3967	Clutch Plate
BNT1998	Screw	BNT3909	Roller Clutch Inner Tube	BNT3968	One-Piece Frame
BNT2119	Screw	BNT3910	Roller Clutch Bearing	BNT3969	Clutch Bar Guide
BNT2120	Click Plate Retainer	BNT3912	Cast Control Cap	BNT3970	Quick-Fire II Clutch Bar
BNT2121	Star Drag Click	BNT3913	Key Washer	BNT3971	Brake Case
BNT2122	Click Pin	BNT3915	Drag Washer	BNT3972	Right Side Plate
BNT2123	Click Spring	BNT3916	Anti-Reverse Ratchet	BNT3973	Turnkey Dial
BNT2127	Star Drag Spacer	BNT3918	Washer		
BNT2144	Washer	BNT3919	Worm Shaft	BNT1713	Brake Collar (green) (accessory)
BNT2200	Handle Nut	BNT3920	Level Wind Guard	BNT3237	Wrench (accessory)

(200630)